

One Up Offroad

Traction Block Installation



All One Up Offroad Parts are for racing use only. They are not for highway use. They may not be legal in your state. This is a common policy in our industry. Many motor and suspension mods say this in the fine print, We choose to do in big print before you buy the parts. All One Up Offroad Parts are built at higher standards then typical light duty truck parts and are much stronger then the OE parts they replace. While not indestructible, these parts are designed to last the life of the truck they are installed on. The owner / driver of the vehicle assumes all responsibility for misusing these parts or operating a vehicle with One Up Offroad Parts installed on it. We cannot control how the parts will be installed, who installs them our how the end user operates a vehicle with the products installed on them. If you purchased these parts and were not informed of this or you are not comfortable with this policy please return the unused products in new condition for a refund. We assume that you have mechanical ability and have worked on a truck before. If you have not worked on a truck before, and drilling holes or replacing a rear axle scares you, then please take your truck to a shop and have the work done. If you get your truck apart and can't get it back together it will be stuck where you disassembled it. A picture is worth a thousand words but take the time to read the steps. If you do it wrong, the system will not work correctly, the ride will be harsh & your time & money will be wasted.



Traction Block Install

For Weld On or Bolt On Rear Axle mountings see below

1st, Install bushings & spacer in the block with Silicone lubricant.

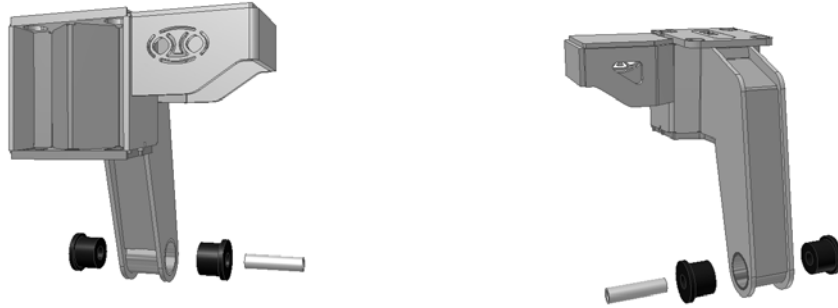

2nd, Install the bottom pin plate in the bottom of the block. The bottom pin plate has the pin welded in it. Install the Universal Adjustable Pin Plate in the top oval in the block. The additional holes go to the rear of the block. These additional holes allow moving the rear axle forward in the truck. Hole **0**, closest to the traction bar mount, is centered on the block as the normal block hole would be. Hole **1**, is 5/8" center to center from Hole **0** and Hole **2** is 1 1/4" from hole zero. Moving the rear axle forward can help with driveline length and allows for more clearance between the tire and the back of the rear fender. You will need the position adjustable top plate to use this feature. If you didn't get the Position Adjustable Top U-Bolt Plate you can only use the **0** position. These are the Position Adjustable Top U-Bolt Plates. **If you didn't get the Position Adjustable Top U-Bolt Plates you can only use the 0 position on the Blocks.**

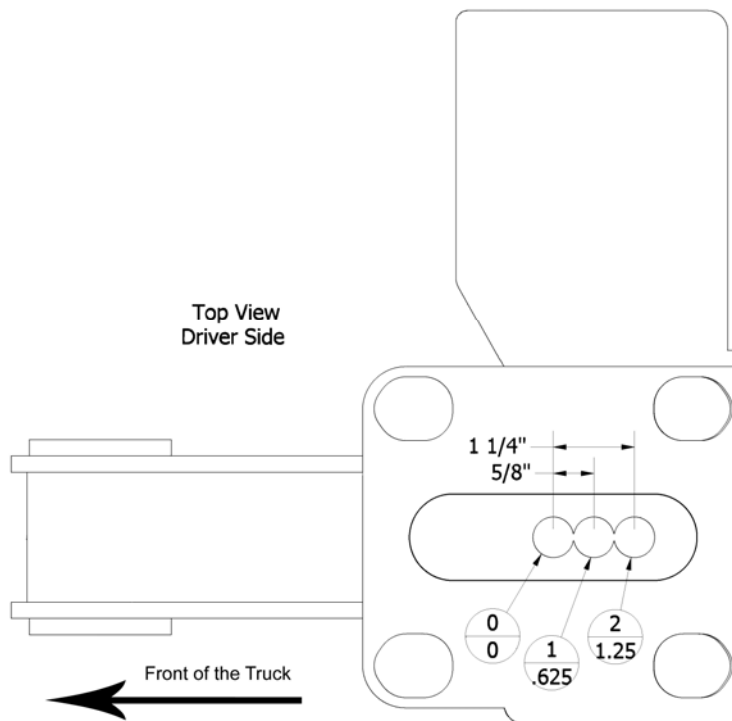

See the Rear Traction Bars, Traction Blocks and Mount Systems Introduction document for more details of the U-Bolt Top Plates shown below.

Position Adjustable Top Plate



Position Adjustable Top Plate with Bump Stop for 6" Lifts and above



3rd, Install the blocks with the bump stop pad pointing to the center and the big bracket is down and in front of the rear axle. Separate the axle from the rear springs with enough clearance to get the block between them. Be mindful of the E-Brake cables, brake lines and wires as not to damage any of these items by letting the axle hang from them. No two installations are the same but you most always will need to replace the brake line with the taller systems. Depending on the truck, these systems are universal, you may need to route the e-brake around the block and the shocks. Be creative and be sure the lines and cables don't rub, chafe or pinch.

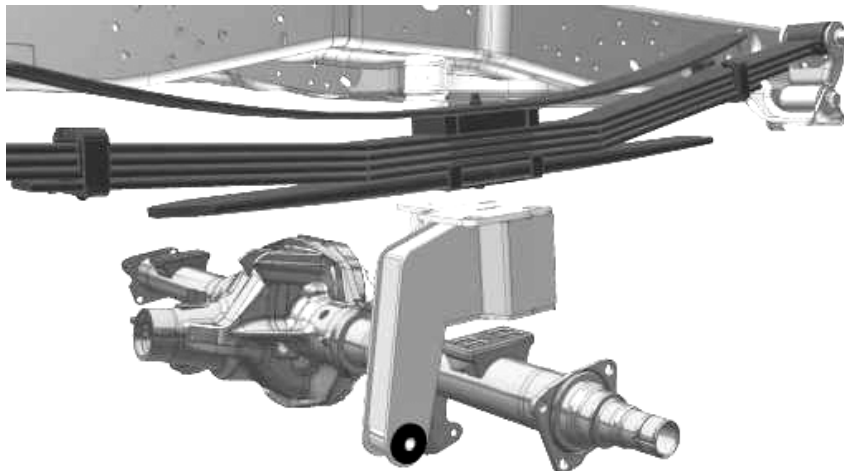
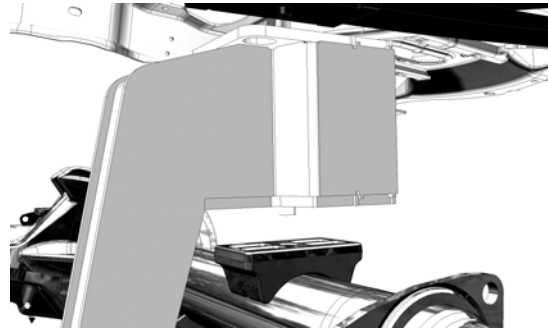
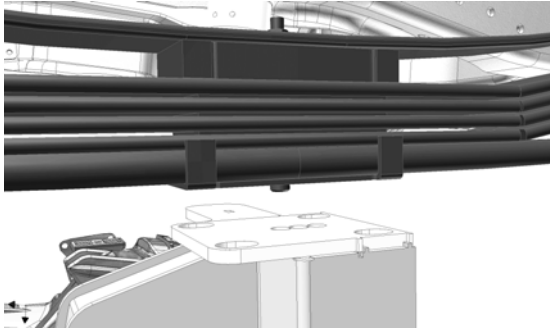



4th, Lube the U-Bolt threads with anti-seize or a light lubrication oil, but not cutting fluid. For 3/4" U-Bolts torque the U-Bolt nuts to 180ftlbs. For 5/8" U-Bolts torque the U-Bolt nuts to 150ftlbs. Be sure the block is aligned straight with the leaf spring and U-Bolts are lined up and straight with the blocks. If it needs adjusting, fix it and re-torque.

You are ready for the Traction Bar Installation

Go to the Instructions for the Traction Bar system you have, Adaptable or Fixed Length.